

# EXPERIENCE<sup>™</sup> metal

The **EXPERIENCE<sup>™</sup>** collection of self-ligating orthodontic brackets offer doctors and patients a variety of options for their orthodontic treatment needs. **EXPERIENCE<sup>™</sup>** brackets minimize friction during initial leveling and aligning and allow for increased torque and rotation control during finishing.



After the metal or ceramic injection process (MIM or CIM), there is a cooling down phase in which the mold retracts. **TOMY** then incorporates an extra step to make the archwire slot consistently precise, using Computer Numerical Controlled (CNC), milling the slot of every **EXPERIENCE<sup>™</sup>** collection to ensure that the slot is exactly .018" or .022". All TOMY archwire slots will then express the exact torque and angulation build into each bracket providing a more predictable result.

## Self Ligation Features

- Increased patient comfort
- Reduced chair time
- Fewer office visits necessary
- Shortened treatment time
- Improved patient hygiene
- Pleasing aesthetics

Optional **laser-fused hooks** provide malleability & the ability to bend

**Dual clip opening methods** for easy clip opening without clip deformation

**CNC milled slot**

**Torque in base** ensures level slot alignment

**Triple chamfered slot** for easy wire engagement and to eliminate arch wire binding & notching

**Smooth swept tie-wings** engineered to minimize occlusal interference

**Compound contoured** pad ensures an anatomically correct fit for each tooth

**Long axis scribe line** for accurate positioning

**80 gauge, micro-etched mesh** for maximum bond strength

**Metal injection molding bracket** for uniformity, strength & precision



**GC Orthodontics**  
GLOBAL EXPERTS IN ORTHODONTICS





# EXPERIENCE ceramic



**EXPERIENCE ceramic** - This ceramic self-ligating twin bracket delivers outstanding aesthetics and performance. The bracket features a rhodium coated clip that blends into the ceramic body of the bracket creating a beautiful appearance. The base is a 100% mechanical lock ensuring both reliable bond strength and easy debonding.

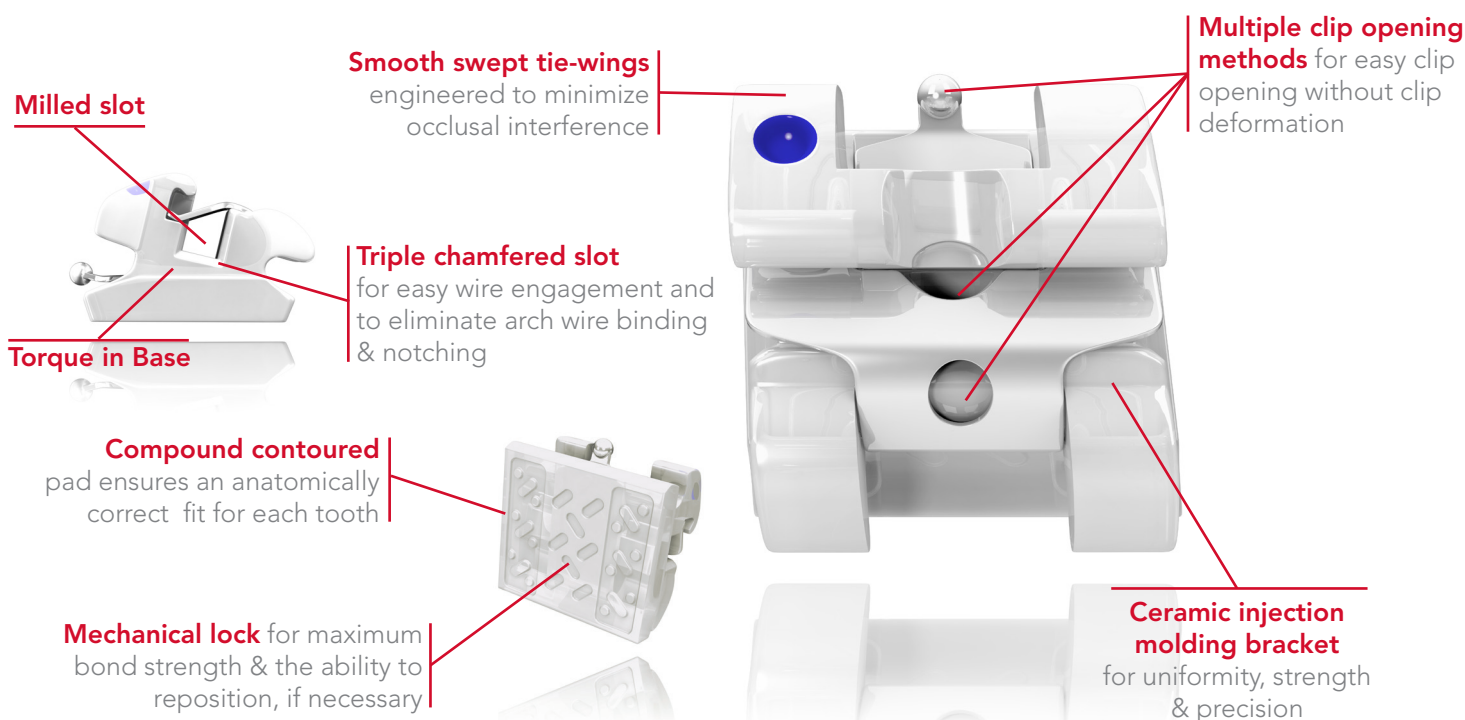

The **EXPERIENCE** collection is manufactured by **TOMY Inc.**, a leading manufacturer of self-ligating brackets since the year 2000. **EXPERIENCE** is available in both a standard and mini size; metal, rhodium, and ceramic material; and a variety of prescription options.

## Bracket & Wire Combination

Pair **EXPERIENCE** with our **Initialloy**, **Bio-Active**, and **Bio-Edge** thermal NiTi arch wires, for increased patient comfort and treatment efficiencies. Rhodium-coated arch wires also available for a completely discrete orthodontic bracket system.

Visit us at [www.gcorthodontics.eu](http://www.gcorthodontics.eu)

GC Orthodontics Europe GmbH  
Harkortstrasse 2  
D-58339 Breckerfeld  
Germany

